

MEETING AND CONFERENCE FACILITIES:

- 137,000 square feet of flexible indoor and outdoor meeting and event space
- Two ballrooms of 16,000 square feet and 14,400 square feet
- More than 28,000 square-foot carpeted exhibit hall
- More than 3,600 square-foot Sleeping Beauty Pavilion that can accommodate up to 300 Guests
- 52 dynamic breakout rooms
- Two spacious lawn areas
- Wireless Internet (Wi-Fi)
- Booth-controlled A/V and lighting
- Remote-control lighting and projection
- State-of-the-art sound system
- Convention dock access for quick and easy set-up and removal of exhibits
- Roll-up doors for ballroom and exhibit hall access

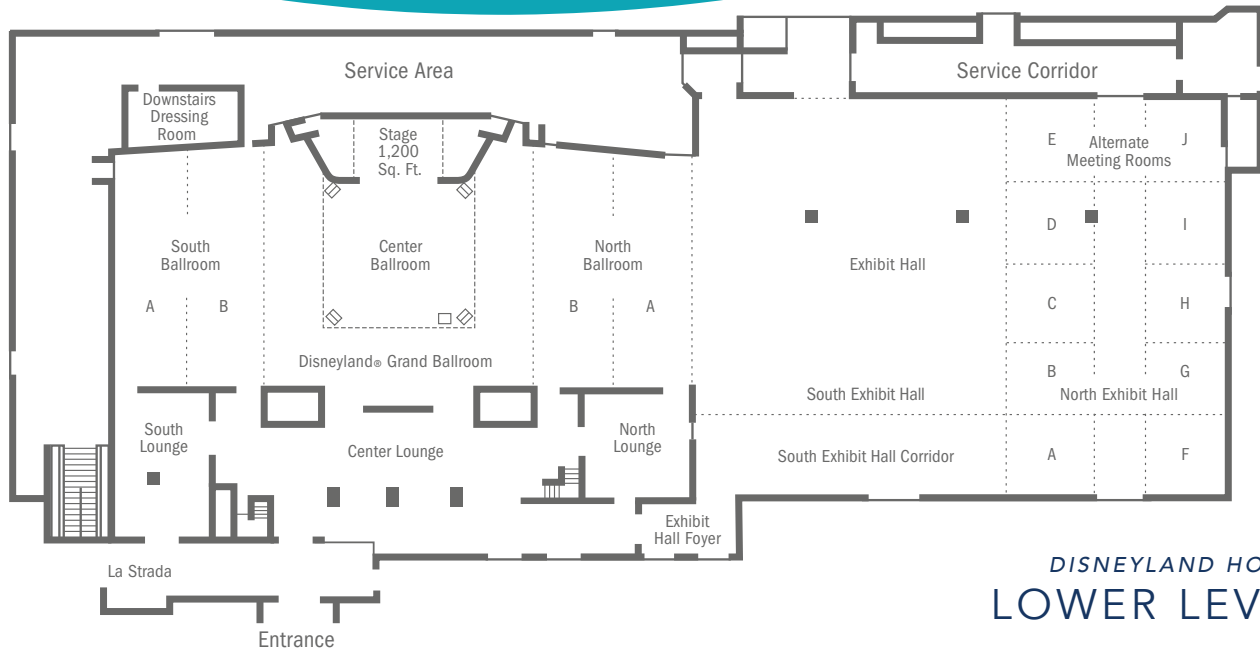

DISNEYLAND HOTEL®
LOWER LEVEL

Room Name	Square Feet	Width	Length	Ceiling Height	Theater Style	School Room	U-Shape	Conference	Banquet Rounds	Reception	Exhibit 8' x 10'	Exhibit 10' x 10'
Grand Ballroom	16,124	100	207	20	1,354	936	•	•	970	1,697	94	89
South Ballroom*	4,719	91	55	20	408	252	90	66	280	497	27	19
Center Ballroom	6,510	100	93	20	640	363	54	48	390	685	40	39
Center Ballroom Expanded	12,139	100	152	20	1,202	693	•	•	730	1,278	•	•
North Ballroom*	4,715	91	55	20	408	252	87	66	280	497	26	19
South Lounge	1,907	54	37	9	•	•	•	•	•	201	•	•
Center Lounge	6,328	56	152	9	•	•	•	•	•	665	•	•
North Lounge	1,449	39	42	9	•	•	•	•	•	153	•	•
La Strada	2,129	41	76	11	•	•	•	•	•	224	•	•
Exhibit Hall	29,116	142	207	20	2,641	1,713	•	•	2,110	3,065	186	170
South Exhibit Hall	16,724	142	120	20	1,617	996	•	•	1,160	1,760	108	89
North Exhibit Hall	12,392	142	87	20	1,143	687	•	•	830	1,304	72	71
Meetings Rooms (each)	•	A-E: 33'6"	F-J: 37'6"	18	60	50	25	25	50	100	6	5

*North and South Ballrooms may be divided as shown by thin dotted lines. Exhibit Hall power available. 2 phase per outlet. Load limits: 125 lbs. per sq. ft. Hall lighting: 80+ candlepower floor level. Compressed air available.
(WIDTH VARIES MEETING ROOMS A-J: 26'6"-32'6") LIMITED SET-UP OPTIONS AVAILABLE BASED ON BREAK OUTS.

DISNEYLAND HOTEL®
UPPER LEVEL

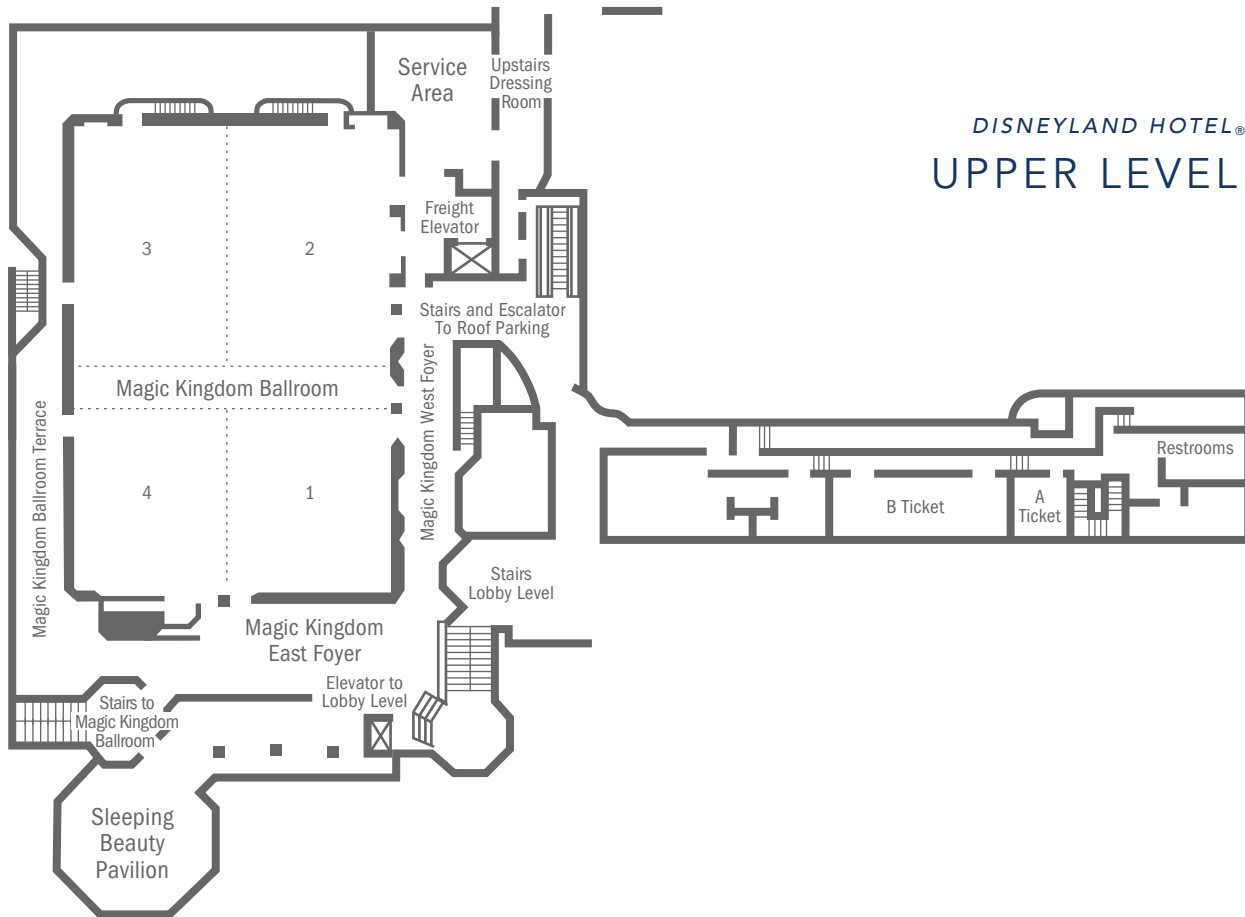

Room Name	Square Feet	Width	Length	Ceiling Height	Theater Style	School Room	U-Shape	Conference	Banquet Rounds	Reception	Exhibit 8' x 10'	Exhibit 10' x 10'
Magic Kingdom Ballroom* (Full)	14,417	104	144	17	1,386	858	•	•	960	1,517	101	72
Magic Kingdom 2/3 Expanded (2/3)	8,767	104	87	17	814	540	•	•	560	1,014	56	34
Ballrooms 2 & 3 (1/2)	7,168	104	71	17	759	405	•	•	400	890	42	31
Ballrooms 1 & 4 (1/3)	5,517	100	55	17	504	315	•	•	320	770	32	26
Ballrooms 1 & 4 Expanded (1/2)	7,121	100	71	17	759	405	•	•	480	890	41	34
Ballroom 1	2,723	49	55	17	240	144	57	42	160	287	16	10
Ballroom 2	3,552	53	71	17	330	180	72	54	240	374	22	17
Ballroom 3	3,522	49	71	17	330	180	72	54	240	371	32	17
Ballroom 4	2,722	49	55	17	240	144	57	42	160	287	16	10
Sleeping Beauty Pavilion	3,439	102	68	13	167	93	36	30	190	300	•	•
A Ticket**	328	18	18	9	21	12	9	12	10	34	•	•
B Ticket**	1,003	18	58	9	91	48	45	48	50	106	•	•

*Free-span construction (no pillars). Movable soundproof walls. Freight elevator: 8'8" (h) x 8' (d). Capacity: 5,500 lbs.

** Suitable for meetings, offices or press rooms.

Load Limits: 55 lbs. per sq. ft.

DISNEYLAND HOTEL®
ADVENTURE TOWER

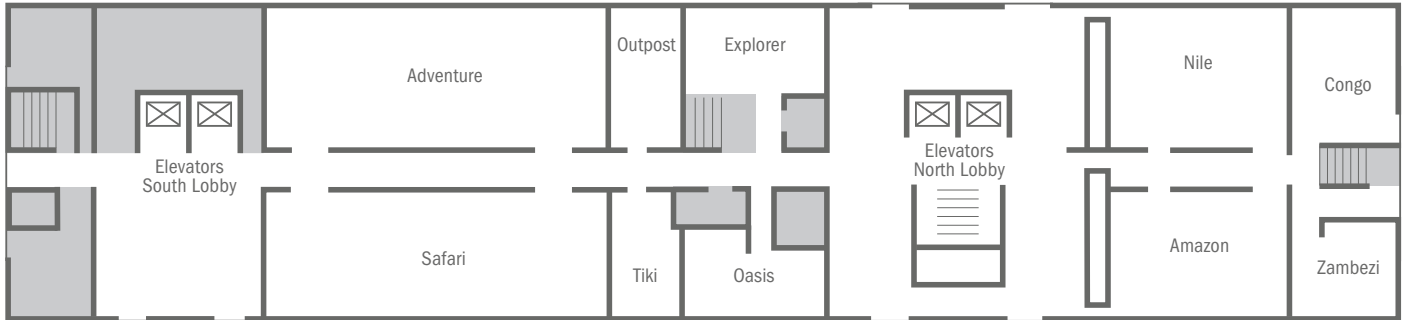

Room Name	Square Feet	Width	Length	Ceiling Height	Theater Style	School Room	U-Shape	Conference	Banquet Rounds	Reception	Exhibit 8' x 10'	Exhibit 10' x 10'
Adventure	1,377	23	61	10	140	81	54	48	100	200	•	•
Adventure Terrace	906	12	70	•	•	•	•	•	•	117	•	•
Safari	1,339	22	61	10	150	81	54	48	100	200	•	•
Safari Terrace	615	10	58	•	•	•	•	•	•	•	•	•
Outpost	280	23	13	10	20	9	•	18	20	29	•	•
Tiki	260	21	13	10	20	9	•	18	10	27	•	•
Explorer	341	15	24	10	25	18	15	18	20	35	•	•
Oasis	417	23	24	10	25	9	15	18	20	43	•	•
Nile	805	24	35	10	63	45	30	30	60	84	•	•
Amazon	773	22	35	10	63	45	30	30	60	81	•	•
Congo	373	24	17	10	35	18	15	18	20	40	•	•
Zambezi	238	15	16	10	21	12	9	12	10	43	•	•

DISNEYLAND HOTEL®
FRONTIER TOWER

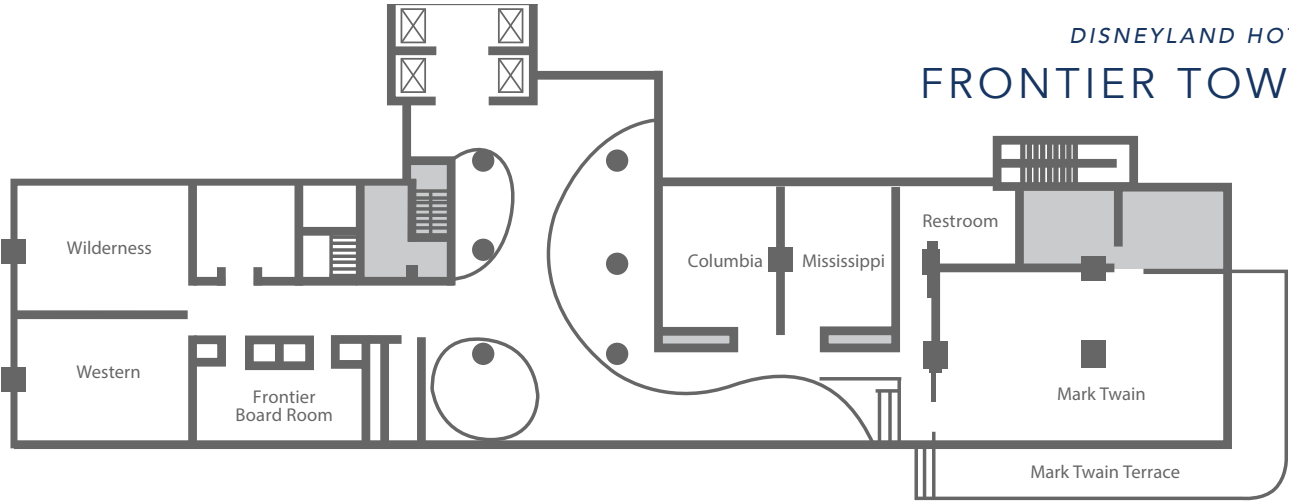

Room Name	Square Feet	Width	Length	Ceiling Height	Theater Style	School Room	U-Shape	Conference	Banquet Rounds	Reception	Exhibit 8' x 10'	Exhibit 10' x 10'
Wilderness	738	30	26	11	55	36	27	24	50	78	•	•
Western	749	30	26	11	55	36	27	24	50	78	•	•
Frontier Boardroom	576	16	36	11	•	•	•	16	•	•	•	•
Columbia	666	29	23	11	60	24	24	24	40	70	•	•
Mississippi	630	28	24	11	48	36	24	18	40	66	•	•
Mark Twain	1,953	57	35	14	167	93	33	24	130	205	•	•
Mark Twain Terrace	2,590	57	35	13	•	•	•	•	•	273	•	•
Frontier Lawn	5,146	145	99	•	•	•	•	•	•	542	•	•

DISNEYLAND HOTEL®
MONORAIL & CASTLE

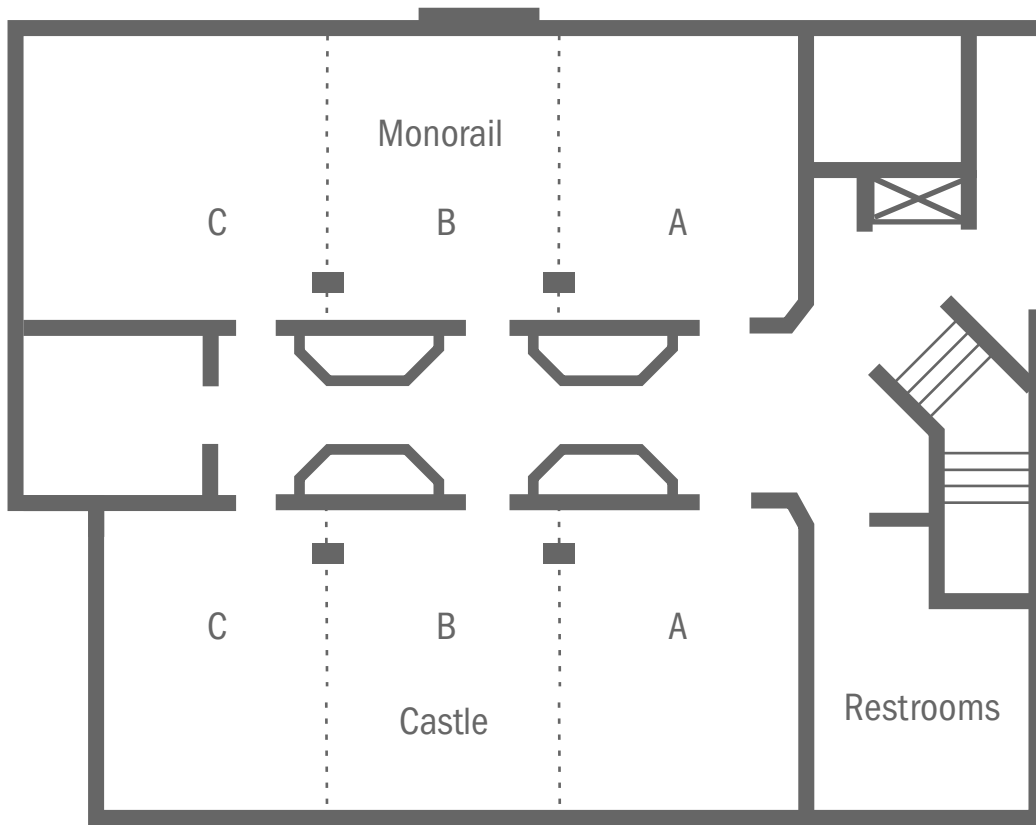

Room Name	Square Feet	Width	Length	Ceiling Height	Theater Style	School Room	U-Shape	Conference	Banquet Rounds	Reception	Exhibit 8' x 10'	Exhibit 10' x 10'
Monorail Room	2,730	34	84	9'	244	126	54	72	170	287	12	10
Monorail C	924	34	31	9'	48	45	30	24	49	49	0	0
Monorail B	801	34	23	9'	48	45	30	24	49	49	0	0
Monorail A	806	34	23	9'	48	45	30	24	49	49	0	0
Monorail A & B	1,707	34	50	9'	150	81	45	36	120	98	0	0
Monorail B & C	1,824	34	58	9'	161	81	45	42	120	98	0	0
Castle Room	2,573	34	75	9'	244	126	69	60	180	270	14	10
Castle C	767	34	22	9'	48	45	30	24	49	49	0	0
Castle B	801	34	23	9'	48	45	30	24	49	49	0	0
Castle A	806	34	23	9'	48	45	30	24	49	49	0	0
Castle A & B	1,706	34	50	9'	163	81	51	42	120	98	0	0
Castle B & C	1,667	34	49	9'	163	81	45	42	120	98	0	0

DISNEYLAND HOTEL®
ADVENTURE LAWN



Room Name	Square Feet	Width	Length	Ceiling Height	Theater Style	School Room	U-Shape	Conference	Banquet Rounds	Reception
Adventure Lawn	14,000	160	363	•	•	•	•	•	680	900
Adventure Gazebo	4,477	94	71	•	30	•	•	•	30	40
Rose Court Garden	6,029	75	106	•	350	•	•	•	120	300

NOTE: Capacity figures subject to change depending on space allocations for audiovisual equipment, staging, dance floor, etc.